



APPEARANCE :



SPECIFICATION

Electrical and Acoustic Characteristics.

Dimensions	23x5mm
AC Impedance	$8 \pm 15\% \Omega$ at 2000Hz
Rated Input Power	2.0W
Max. input power	2.5W
Resonance Frequency	$500 \pm 20\%$ Hz
Output Sound Pressure Level	$85 \pm 3\text{dB}/0.1\text{M}$ 0.1W at 0.8,1.0,1.2,1.5KHz Average
Frequency Response	Fo~20KHz
Operating Temperature	-20~+65°C
Storage Temperature	-30~+70°C

DIMENSIONS :

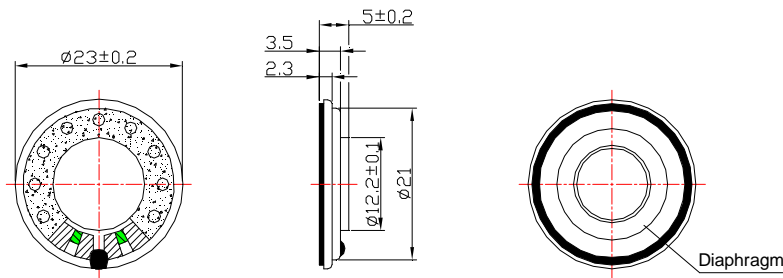

FREQUENCY RESPONSE :

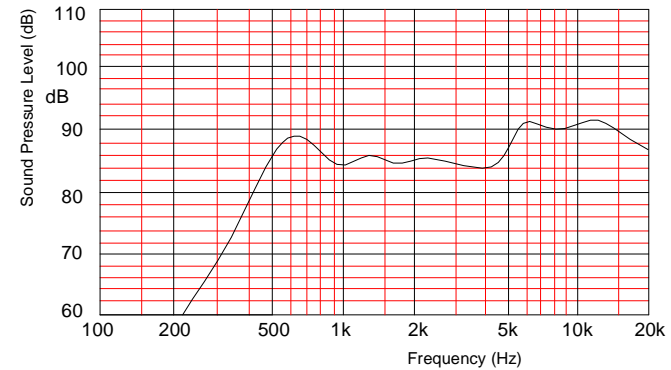

<small>UNLESS OTHERWISE SPECIFIED DIMENSION ARE IN MILLIMETER AND (INCHES)</small> <small>DECIMALS ANGLES</small> <small>.XX +0.50 (0.02)</small> <small>.XXX:0.025 (0.001) ±1°</small> <small>DO NOT SCALE DRAWING</small>	MATERIAL SILICONE RUBBER 60°		TIANER TECHNOLOGY CO., LTD. http://www.itianer.com		
	FINISH BLACK		TITLE Loud Speaker		
	DWN BY	DATE	UNIT mm	DWG NO/ PART NO TE-DL23A-8H5	REV 01
	CHK BY	DATE	DESIGN J.M.	DATE 09/08/22	SCALE 5:1 RELEASE DATE 2009/12/23 SHEET

